

# Toplite Applications

## Walls below DPC

### from Tarmac Topblock

Toplite products can be used to construct walls below ground. They can be used in sulfate soil conditions as shown in the table opposite and as confirmed by British Board of Agrément Certificate No. 02/3896. In addition they are resistant to the freeze / thaw conditions likely to occur below the DPC, as confirmed by tests to MOAT 12.

Toplite Foundation blocks should be specified to construct 260-300mm solid walls below ground. They are intended to support cavity or solid walls of equivalent width above ground. Toplite Standard (or any higher strength Toplite product) can be

used to construct internal and external walls below ground.

Toplite GTI is recommended for use in the construction of inner leaves only below ground and is suitable for use in Class D-1 sulfate soil conditions as confirmed by British Board of Agrément Certificate Nos. 02/3896.



### Sulfate soil conditions

| Toplite aircrete blocks | Sulfate soil conditions |      |      |
|-------------------------|-------------------------|------|------|
|                         | DS-1                    | DS-2 | DS-3 |
| Toplite Foundation      | ✓                       | ✓    | ✓    |
| Toplite GTI*            | ✓                       |      |      |
| Toplite Standard        | ✓                       | ✓    | ✓    |
| Toplite '7'             | ✓                       | ✓    | ✓    |

**Note** \*Suitable for use as the inner leaf of cavity walls and internal walls below dpc

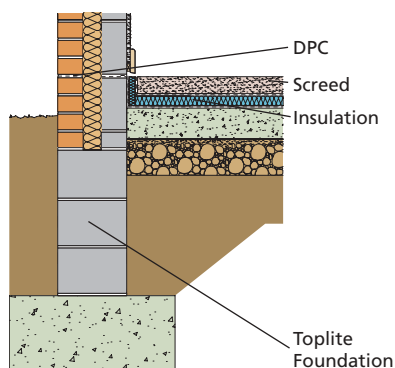

### Alternative suitable products:

Products from the Durox, Hemelite and Topcrete ranges may also be suitable for this application.